

IEC Appliance Connector C14 with Fuseholder 1- or 2-pole



Screw-On Version



Snap-In Version



Pick & Place Version



**Description**

- Panel Mount: Sandwich/rear-side
- 2 Functions: Inlet Protection class I, with or without Fuseholder for fuse-links 5 x 20 mm on the rear-side 1- or 2-pole
- For PCB mounting
- Pick and place version

**Approvals**

- VDE License Number: 40024857
- UL License Number: E93617, E96454
- CSA License Number: 38456

**Characteristics**

- PCB mount with snap-in or screw-on feet
- Suitable for automatic PCB assembling
- All single elements are already wired
- Fuseholder on the inside of the equipment prevents accidental use of incorrect fuse-links by the user
- With or without rear-side insulation cover
- Blister tray meets ESD requirements
- Qualified for use in equipment according IEC/EN 60950

**Other versions on request**

- Ground terminal with quick-connect terminal 6,3 x 0,8 mm
- Ground terminal with solder terminal
- For protection class II

**Weblinks**

[Approvals](#), [RoHS](#), [CHINA-RoHS](#), [e-Store](#), [SCHURTER-Stock-Check](#), [Distributor-Stock-Check](#)

**Technical Data**

Ratings IEC	10 A / 250 VAC; 50 Hz
Ratings UL/CSA	10 A / 250 VAC; 60 Hz
Dielectric Strength	> 3 kVAC between L-N > 4 kVAC between L/N-PE (1 min/50 Hz)
Allowable Operation Temp.	-25 °C to 70 °C
Degree of Protection	from front side IP 40 acc. to IEC 60529
Protection Class	Suitable for appliances with protection class I acc. to IEC 61140
Terminal	For PCB mounting
Panel Thickness s	Snap-in: 1.5/ 2/ 2.5/ 3 mm
Material: Housing	Thermoplastic, black, UL 94V-0

Appliance-Inlet/-Outlet	C14 acc. to IEC/EN 60320-1, UL 498, CSA C22.2 no. 42 (for cold conditions) pin-temperature 70 °C, 10A, Protection class I
Fuseholder	optional, 1 or 2 pole, Shocksafe category PC2 acc. to IEC 60127-6, for fuse-links 5 x 20 mm
Rated Power Acceptance @ Ta 23 °C	5 x 20: 3.15 W (1 pole)/ 2.5 W (2-pole) per pole
Power Acceptance @ Ta > 23 °C	Admissible power acceptance at higher ambient temperature see derating curves

**Dimensions**

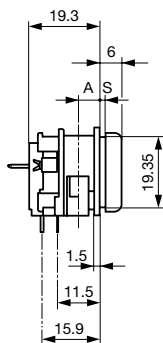
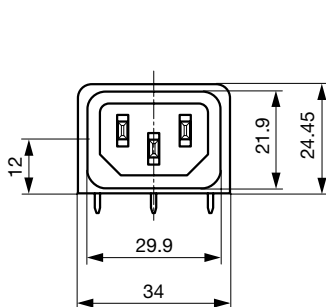

A = 6 mm for standard versions  
A = 5 mm for pick and place versions  
S = 0 mm for mounting from rear-side

with insulation cover

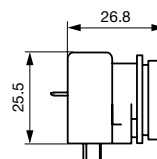

for mounting from rear-side

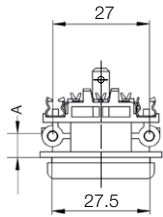

A = 6 mm for standard versions  
A = 5 mm for pick and place versions

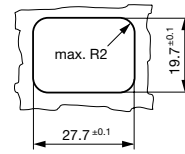

for sandwich mounting

## Drilling diagrams

without fuseholder

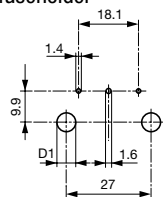

d1 for snap-in mounting =  $6 \pm 0.05$   
d1 for self-tapping screw =  $3.6 \pm 0.1$

with 1-pole fuseholder

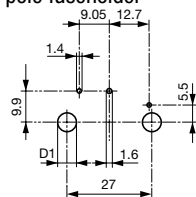

d1 for snap-in mounting =  $6 \pm 0.05$   
d1 for self-tapping screw =  $3.6 \pm 0.1$

with 2-pole fuseholder

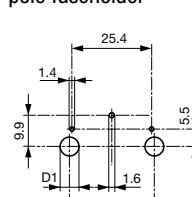

d1 for snap-in mounting =  $6 \pm 0.05$   
d1 for self-tapping screw =  $3.6 \pm 0.1$

Pick and Place versions  
without / with 1-pole or  
2-pole fuseholder

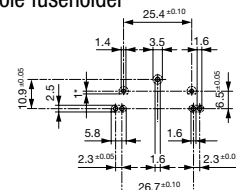

1\* only for protection class II

## Derating Curves for Fuseholders

1-pole

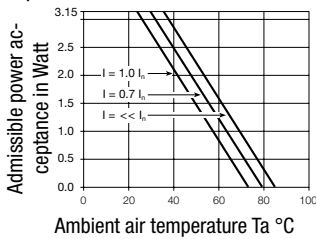

2-pole

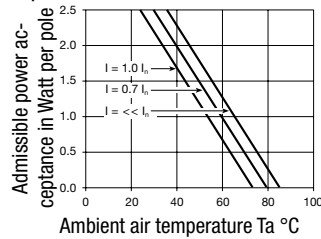

## Variants

Distributor-Stock-Check | SCHURTER-Stock-Check | e-Store

Mounting side	Panel mounting	Panel Thickness s [mm]	Fuseholder	Ground terminal 4.8 x 0.8 mm	Ground terminal direction	Packaging	Order Number
Sandwich	Screw-on	1.5	-	●	straight	-	GSF1.0001.31
Sandwich	Screw-on	2	-	●	straight	-	GSF1.0001.41
Sandwich	Screw-on	2.5	-	●	straight	-	GSF1.0001.51
Sandwich	Screw-on	3	-	●	straight	-	GSF1.0001.61
Sandwich	Screw-on	1.5	-	●	angled to pin axis	-	GSF1.0002.31
Sandwich	Screw-on	2	-	●	angled to pin axis	-	GSF1.0002.41
Sandwich	Screw-on	2.5	-	●	angled to pin axis	-	GSF1.0002.51
Sandwich	Screw-on	3	-	●	angled to pin axis	-	GSF1.0002.61
Sandwich	Snap-in	1.5	-	●	straight	-	GSF1.0201.31
Sandwich	Snap-in	2	-	●	straight	-	GSF1.0201.41
Sandwich	Snap-in	2.5	-	●	straight	-	GSF1.0201.51
Sandwich	Snap-in	3	-	●	straight	-	GSF1.0201.61
Sandwich	Snap-in	1.5	-	●	angled to pin axis	-	GSF1.0202.31
Sandwich	Snap-in	2	-	●	angled to pin axis	-	GSF1.0202.41
Sandwich	Snap-in	2.5	-	●	angled to pin axis	-	GSF1.0202.51
Sandwich	Snap-in	3	-	●	angled to pin axis	-	GSF1.0202.61
Sandwich	Screw-on	1.5	1 pole	●	straight	-	GSF1.1001.31
Sandwich	Screw-on	2	1 pole	●	straight	-	GSF1.1001.41
Sandwich	Screw-on	2.5	1 pole	●	straight	-	GSF1.1001.51

Mounting side	Panel mounting	Panel Thickness s [mm]	Fuseholder	Ground terminal 4.8 x 0.8 mm	Ground terminal direction	Packaging	Order Number
Sandwich	Screw-on	3	1 pole	●	straight	-	GSF1.1001.61
Sandwich	Screw-on	1.5	1 pole	●	angled to pin axis	-	GSF1.1002.31
Sandwich	Screw-on	2	1 pole	●	angled to pin axis	-	GSF1.1002.41
Sandwich	Screw-on	2.5	1 pole	●	angled to pin axis	-	GSF1.1002.51
Sandwich	Screw-on	3	1 pole	●	angled to pin axis	-	GSF1.1002.61
Sandwich	Snap-in	1.5	1 pole	●	straight	-	GSF1.1201.31
Sandwich	Snap-in	2	1 pole	●	straight	-	GSF1.1201.41
Sandwich	Snap-in	2.5	1 pole	●	straight	-	GSF1.1201.51
Sandwich	Snap-in	3	1 pole	●	straight	-	GSF1.1201.61
Sandwich	Snap-in	1.5	1 pole	●	angled to pin axis	-	GSF1.1202.31
Sandwich	Snap-in	2	1 pole	●	angled to pin axis	-	GSF1.1202.41
Sandwich	Snap-in	2.5	1 pole	●	angled to pin axis	-	GSF1.1202.51
Sandwich	Snap-in	3	1 pole	●	angled to pin axis	-	GSF1.1202.61
Sandwich	Screw-on	1.5	2-pole	●	straight	-	GSF1.2001.31
Sandwich	Screw-on	2	2-pole	●	straight	-	GSF1.2001.41
Sandwich	Screw-on	2.5	2-pole	●	straight	-	GSF1.2001.51
Sandwich	Screw-on	3	2-pole	●	straight	-	GSF1.2001.61
Sandwich	Screw-on	1.5	2-pole	●	angled to pin axis	-	GSF1.2002.31
Sandwich	Screw-on	2	2-pole	●	angled to pin axis	-	GSF1.2002.41
Sandwich	Screw-on	2.5	2-pole	●	angled to pin axis	-	GSF1.2002.51
Sandwich	Screw-on	3	2-pole	●	angled to pin axis	-	GSF1.2002.61
Sandwich	Snap-in	1.5	2-pole	●	straight	-	GSF1.2201.31
Sandwich	Snap-in	2	2-pole	●	straight	-	GSF1.2201.41
Sandwich	Snap-in	2.5	2-pole	●	straight	-	GSF1.2201.51
Sandwich	Snap-in	3	2-pole	●	straight	-	GSF1.2201.61
Sandwich	Snap-in	1.5	2-pole	●	angled to pin axis	-	GSF1.2202.31
Sandwich	Snap-in	2	2-pole	●	angled to pin axis	-	GSF1.2202.41
Sandwich	Snap-in	2.5	2-pole	●	angled to pin axis	-	GSF1.2202.51
Sandwich	Snap-in	3	2-pole	●	angled to pin axis	-	GSF1.2202.61
Rear-Side	Screw-on	6	-	●	straight	-	GSF1.0001.01
Rear-Side	Screw-on	6	-	●	angled to pin axis	-	GSF1.0002.01
Rear-Side	Snap-in	6	-	●	straight	-	GSF1.0201.01
Rear-Side	Snap-in	6	-	●	angled to pin axis	-	GSF1.0202.01
Rear-Side	Screw-on	6	1 pole	●	straight	-	GSF1.1001.01
Rear-Side	Screw-on	6	1 pole	●	angled to pin axis	-	GSF1.1002.01
Rear-Side	Snap-in	6	1 pole	●	straight	-	GSF1.1201.01
Rear-Side	Snap-in	6	1 pole	●	angled to pin axis	-	GSF1.1202.01
Rear-Side	Screw-on	6	2-pole	●	straight	-	GSF1.2001.01
Rear-Side	Screw-on	6	2-pole	●	angled to pin axis	-	GSF1.2002.01
Rear-Side	Snap-in	6	2-pole	●	straight	-	GSF1.2201.01
Rear-Side	Snap-in	6	2-pole	●	angled to pin axis	-	GSF1.2202.01
Rear-Side	Metal snaps	6	-	●	angled to pin axis	Blister tray	GSF1.3402.01
Rear-Side	Metal snaps	6	1 pole	●	angled to pin axis	Blister tray	GSF1.4402.01
Rear-Side	Metal snaps	6	2-pole	●	angled to pin axis	Blister tray	GSF1.5402.01

Insulation cover must be ordered separately. Order No. 0098.0078

**Packaging unit** 50 Pcs

## Accessory

### Description



Assorted Covers  
Rear Cover

0098.0078